

Lead-Lined Drywall

Radiation Shielding

Fast Facts

Product	Lead-lined drywall
Usage	Shielding x-ray rooms; soundproofing
Construction	1/32" to 1/8" lead thickness, 1/2" or 5/8" drywall thickness
Dimensions	48" x 96", 48" x 108", 48" x 120"
Weight	Varies depending on lead and drywall thickness

See back for detailed rendering of product installation



Close-up of edge

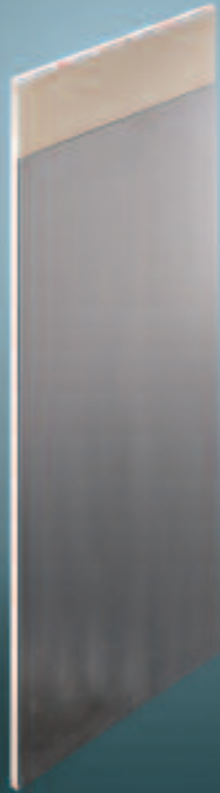

Description

NELCO lead-lined drywall products are designed to cover walls and ceilings in x-ray rooms in chiropractic offices, dental offices, hospitals, and other medical facilities. Lead-lined drywall has significant soundproofing capabilities as well.

NELCO manufactures standard 1/2" or 5/8" fire-coded or non fire-coded drywall laminated with a single, uniform sheet of defect-free lead of a specified thickness. We offer several drywall sizes and lead thicknesses to accommodate various customer needs and physics requirements. Our experts are available to assist in determining the appropriate drywall size, lead thickness, and wall layout to meet all site requirements.

NELCO supplies 2", 3", or 4" lead batten strips and lead discs or tabs with lead thicknesses equal to that of the drywall. Batten strips shield the seams between two pieces of drywall, and lead discs or tabs cover the heads of the drywall screws used to fasten the drywall into place. We also offer lead pieces of equal thickness to line electrical outlets, wall outlets, light switches, and more.

NELCO supports the proper handling and disposal of all lead in a safe and environmentally responsible way.



All NELCO lead-lined drywall products are manufactured under strict NELCO quality guidelines

WWW.NELCO-USA.COM
1-800-NELCO-13

BENEFITS

Versatility	<i>for use in new or remodeled rooms</i>
Flexibility	<i>dimensions and thicknesses to meet any design need</i>
Availability	<i>quick turnaround time</i>
Delivery	<i>proven on-time deliveries from one of many manufacturing facilities across the US</i>
Installation Options	<i>NELCO installation teams available upon request</i>
Warranty	<i>full 12-month warranty</i>



Lead-Lined Drywall Corner Construction Wall Detail

TECHNICAL SPECIFICATIONS

<i>Dimensions</i>	48" x 96", 48" x 108", 48" x 120"
<i>Lead Lining</i>	1/32" to 1/8" lead thickness
<i>Drywall</i>	1/2" or 5/8" drywall thickness
<i>UL Classification</i>	UL V439 5/8" drywall available upon request
<i>Lead</i>	Meets Federal Specification QQ-L-201 F: Lead Sheet

NELCO, INC



R20718

GYPSUM BOARD
FIRE RESISTANCE CLASSIFICATION
SEE UL PRODUCTS CERTIFIED FOR CANADA DIRECTORY
AND UL FIRE RESISTANCE DIRECTORY
ISSUE NO. D-2686



METAL STUD
LEAD CORNER BATTEN

Drawing not to scale

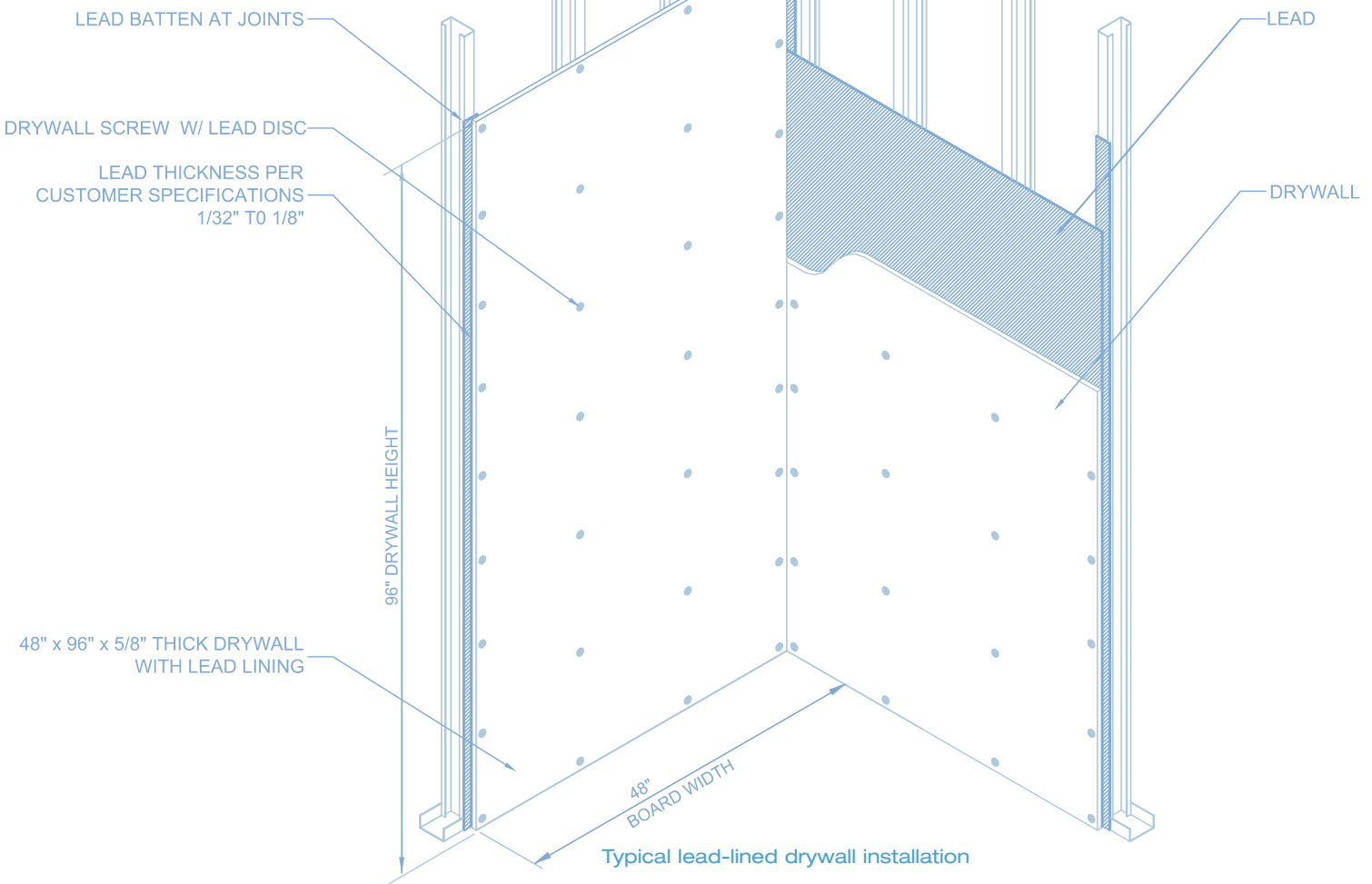

Other details regarding manufacturing, materials, installation requirements, structural specifications, custom options, financing and physics may be obtained from your NELCO representative.

Lists of installed references are available upon request.

06v1